

Visual Indicating Fuseholder

For $\frac{1}{4}$ " x $1\frac{1}{4}$ " (6.4mm x 31.8mm) Pin Indicating Fuses

HLD
HLD-HH

Dimensional Data

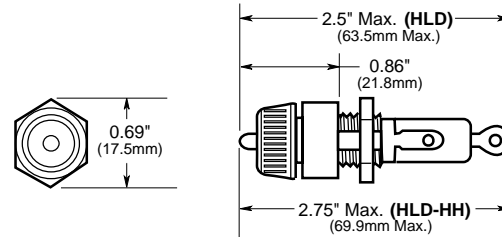

Catalog Symbol: HLD and HLD-HH
 Visual Indicating Fuseholder
 Ampere Rating: 15 Amperes
 Voltage Rating: 250 Volts
 Temperature Rating (RTI): 130°C
 Agency Approvals:
 U.L. Recognized, HLD Guide IZLT2, File E14853

Punched Mounting Hole

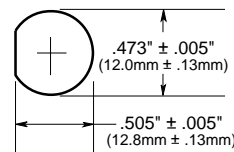

Electrical Ratings

Symbol	Amps	Volts AC	Features
HLD	15	250	Solder terminals
HLD-HH	15	250	$\frac{1}{4}$ " quick-connect terminals

CE logo denotes compliance with European Union Low Voltage Directive (50-1000 Vac, 75-1500 Vdc). Refer to BIF document #8002 or contact Bussmann Application Engineering at 314-527-1270 for more information.

General Information:

- For use with GBA and GLD fuses.
- Bayonet-type transparent knob permits visual indication of "opened" pin indicating fuses.

This bulletin is intended to clearly present comprehensive product data and provide technical information that will help the end user with design applications. Bussmann reserves the right, without notice, to change design or construction of any products and to discontinue or limit distribution of any products. Bussmann also reserves the right to change or update, without notice, any technical information contained in this bulletin. Once a product has been selected, it should be tested by the user in all possible applications.