

# T-Tron® Very Fast Acting Fuses

## Class T — 600 Volt, 1-800 Amps

**JJS**



**Catalog Symbol:** JJS

Current Limiting

Very Fast Acting

**Ampere Rating:** 1 to 800 Amperes

**Voltage Rating:** 600 Volts AC (or less)\*

**Interrupting Rating:** 200,000A RMS Sym.

**Agency Approval:**

UL Listed, Std. 248-15, Class T, Guide JDDZ, File E4273

CSA Certified, C22.2 No. 248.15, Class 1422-02, File 53787

**Catalog Numbers**

JJS-1	JJS-45	JJS-200
JJS-2	JJS-50	JJS-225
JJS-3	JJS-60	JJS-250
JJS-6	JJS-70	JJS-300
JJS-10	JJS-80	JJS-350
JJS-15	JJS-90	JJS-400
JJS-20	JJS-100	JJS-450
JJS-25	JJS-110	JJS-500
JJS-30	JJS-125	JJS-600
JJS-35	JJS-150	JJS-800
JJS-40	JJS-175	—

**Carton Quantity and Weight—JJS-T-TRON (600 Volts AC)**

Catalog Number	Carton Qty.	Weight**	
		Lbs.	Kg.
1-30	10	0.33	0.149
35-60	10	0.82	0.371
70-100	5	0.51	0.231
110-200	1	0.192	0.087
225-400	1	0.46	0.208
450-600	1	0.85	0.385
800	1	1.65	0.748

\*15-400A rated 300 VDC and 10 KAIC.

\*\*Weight per carton.

**Dimensional Data**

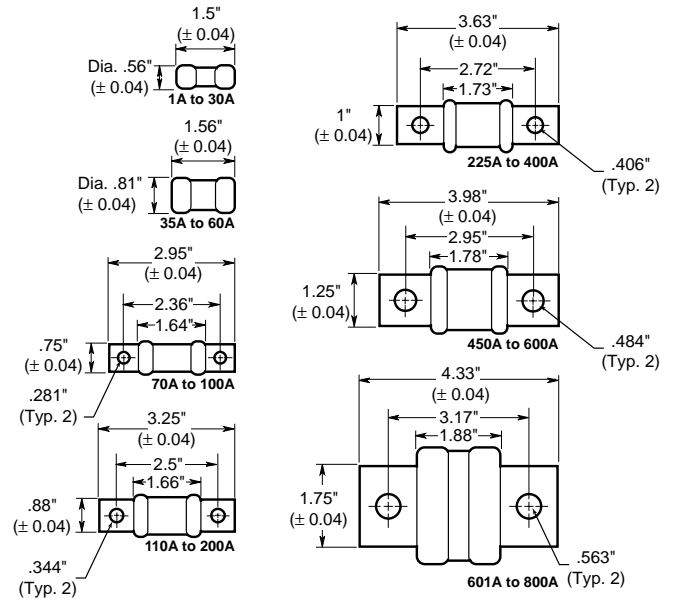

- Small, space-saving fuses provide a high degree of current limitation on short-circuits for excellent component protection.
- Commonly applied in electric heat circuits, load center, disconnect switches, and meters.
- The small size of the T-Tron fuses permits installation in panelboards and control centers for system upgrading when existing circuit breakers cannot safely interrupt larger available short-circuit currents.
- High speed of response for semiconductor protection.

**Standard T Fuseblocks (600V) Catalog Data**

Amps	Poles	Catalog Numbers	
		Screw	Box Lug
½	1	T60030-1SR	T60030-1CR
	2	T60030-2SR	T60030-2CR
30	3	T60030-3SR	T60030-3CR
	1	T60060-1SR	T60060-1CR
31	2	T60060-2SR	T60060-2CR
	3	T60060-3SR	T60060-3CR
61	1	—	T60100-1CR
	2	—	T60100-2CR
100	3	—	T60100-3CR
	1	—	T60200-1C
101-200	3	—	1B0089
	1	—	T60400-1C
201-400	1	—	T60600-1C

CE CE logo denotes compliance with European Union Low Voltage Directive (50-1000 VAC, 75-1500 VDC). Refer to BIF document #8002 or contact Bussmann Application Engineering at 314-527-1270 for more information.

# T-Tron® Very Fast-Acting Fuses

## Class T — 600 Volt, 1-800 Amps

JJS

### Current Limitation Curves

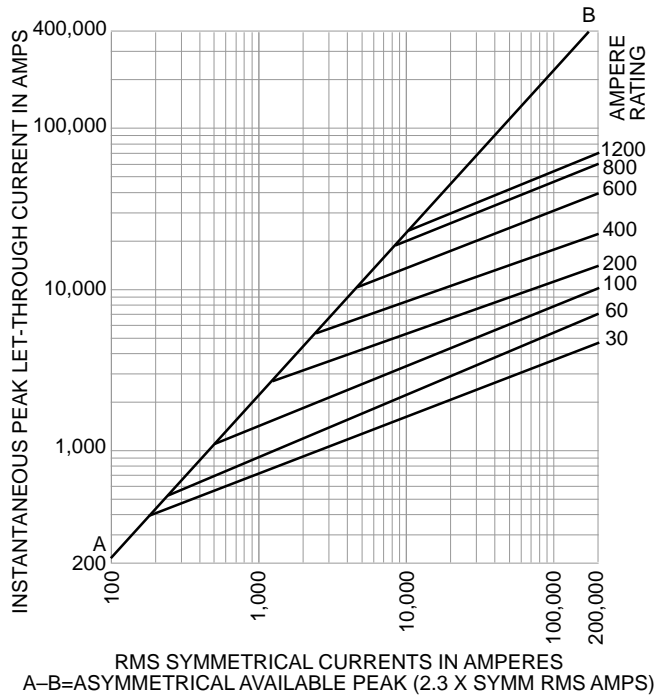

### Time-Current Characteristic Curves—Average Melt

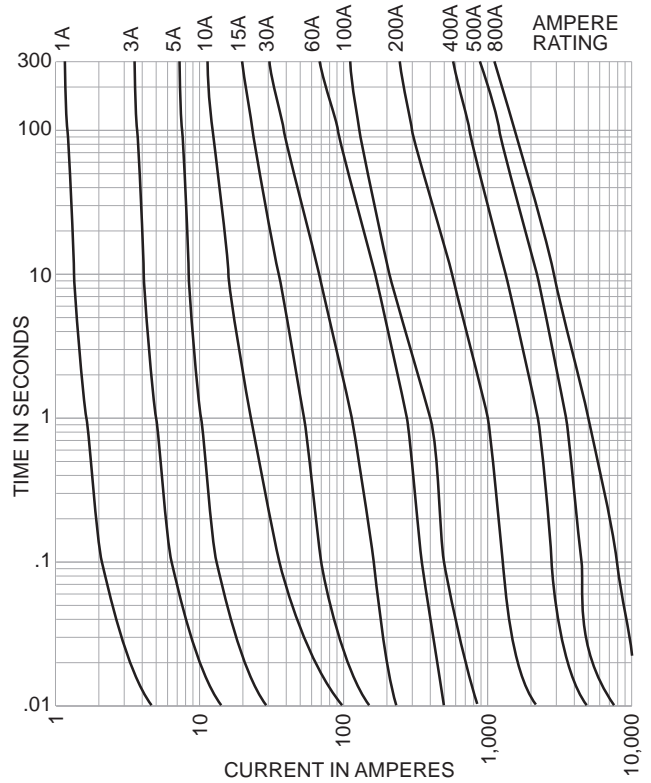

### Custom Designs

- Printed circuit board variations available.

### JJS-60V

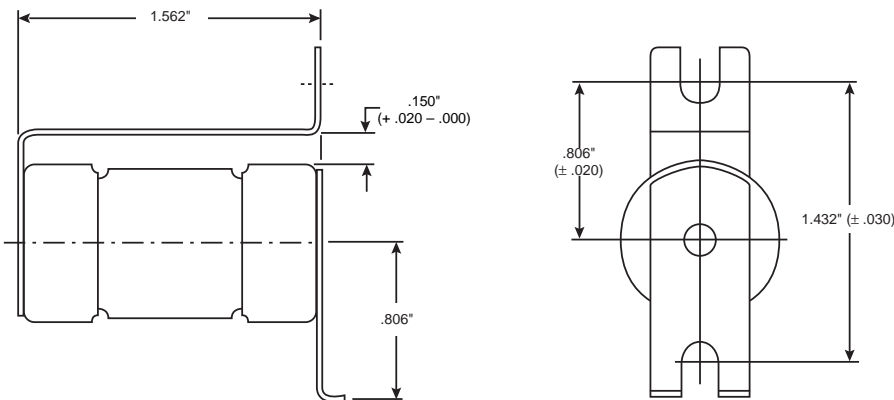

This bulletin is intended to clearly present comprehensive product data and provide technical information that will help the end user with design applications. Bussmann reserves the right, without notice, to change design or construction of any products and to discontinue or limit distribution of any products. Bussmann also reserves the right to change or update, without notice, any technical information contained in this bulletin. Once a product has been selected, it should be tested by the user in all possible applications.